

For Ages

6+

DivaStarz
We know what's up!™



55200-0920

Diva Cruiser™

vehicle

INSTRUCTIONS

Contents:

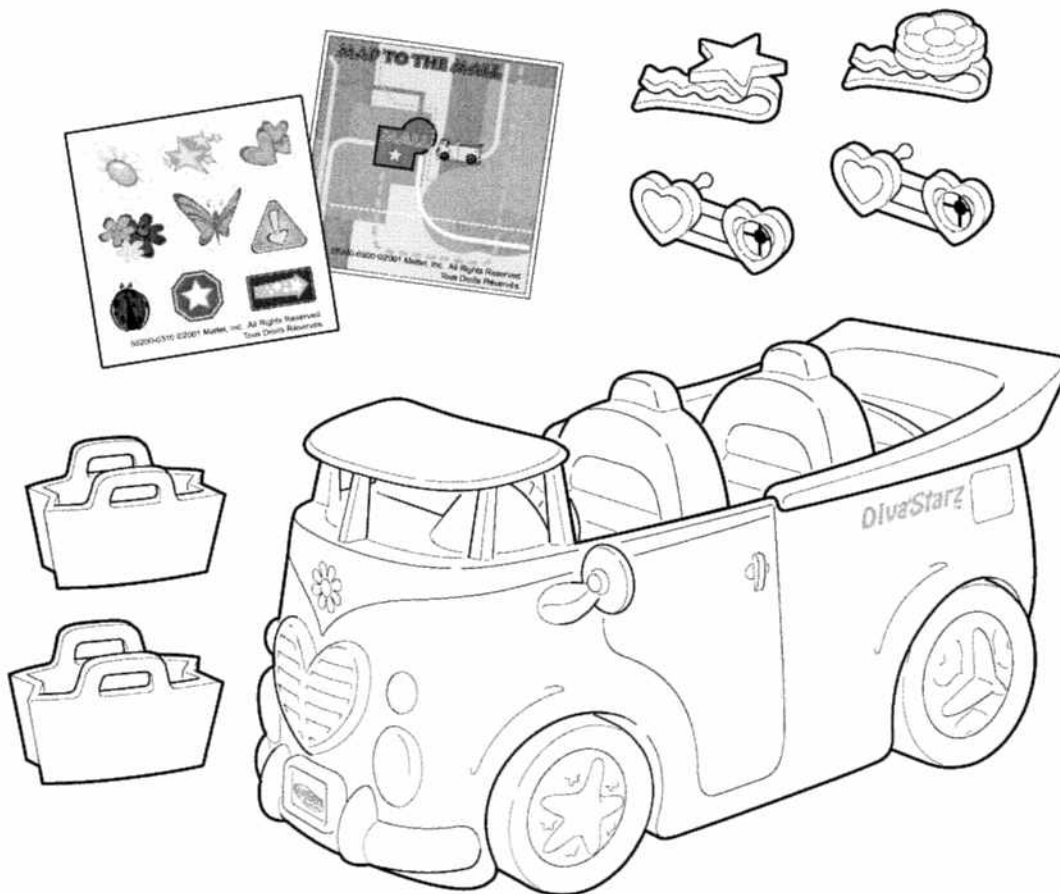

Please remove everything from the package and compare to the contents shown here.

If any items are missing, please call 1-800-524-TOYS.

Keep these instructions for future reference as they contain important information.

ADULTS NOTE: Cut the plastic attachments with scissors and discard pieces.

© 2001 Mattel, Inc., El Segundo, CA 90245 U.S.A. All Rights Reserved.

LET'S PLAY!

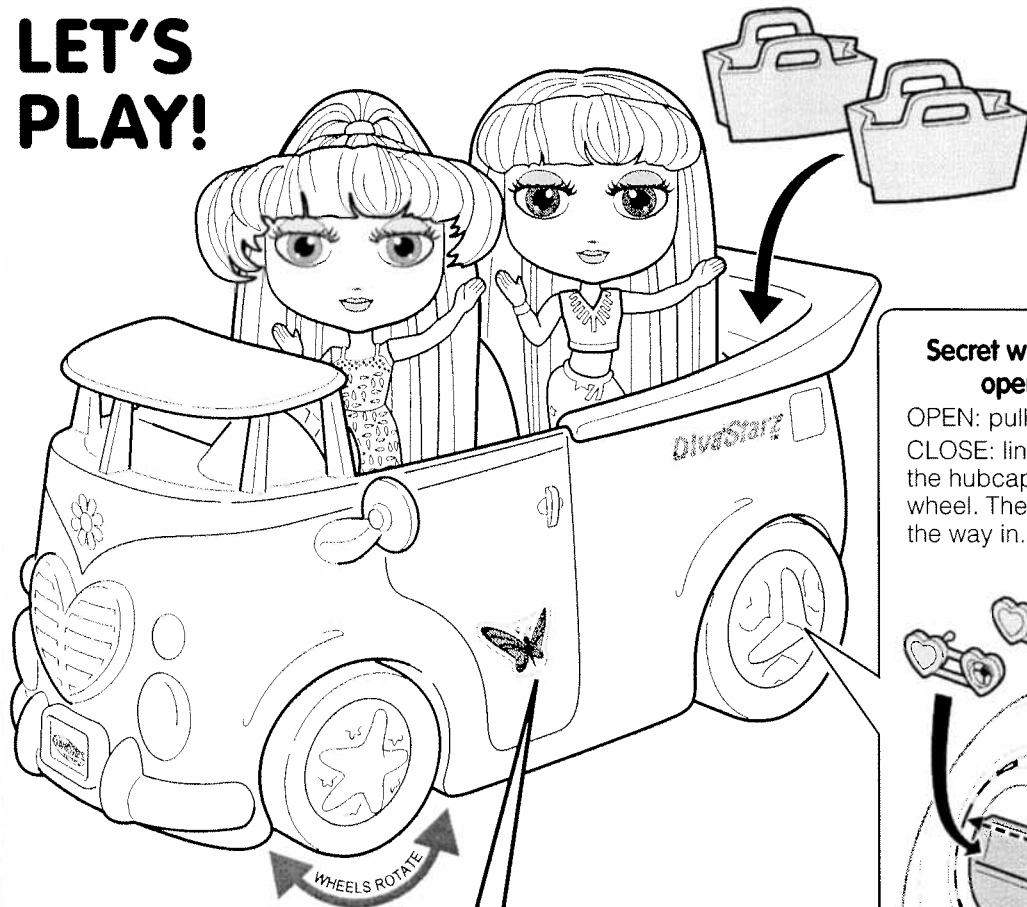

Secret wheel compartment opens for storage!

OPEN: pull out left rear hubcap.
CLOSE: line up the (3) tabs on the hubcap with the slots in the wheel. Then push the hubcap all the way in.

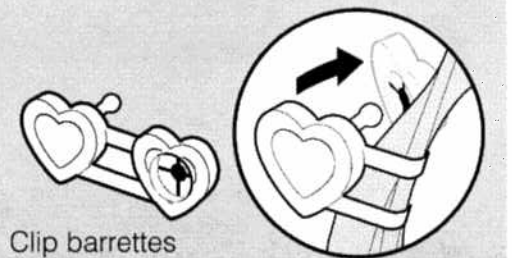
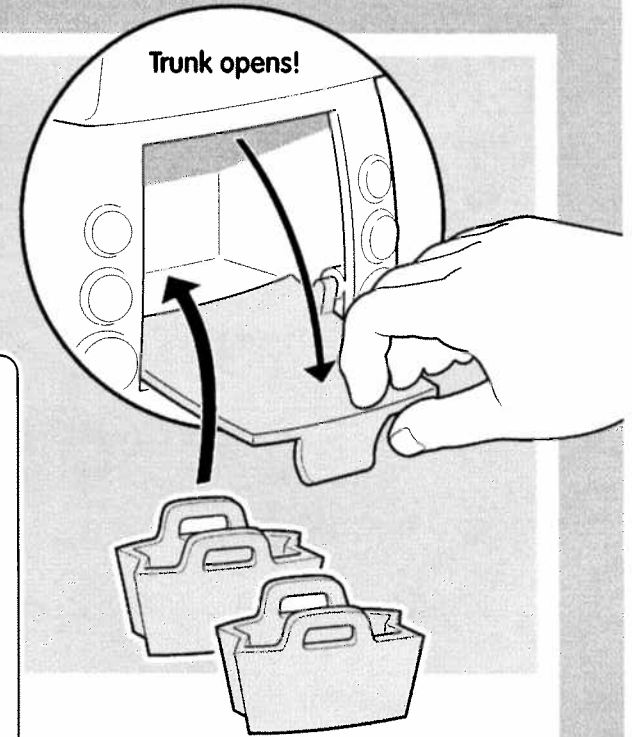
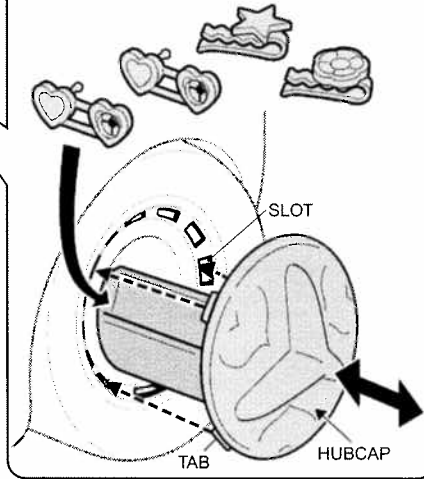

Clip barrettes and bobby pins to doll's hair.

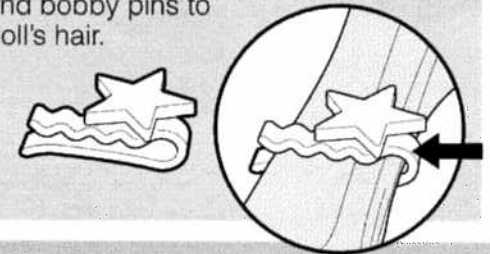

Peel stickers from the sticker sheet then apply them to the Diva Cruiser™ vehicle.

Stickers apply best to flat smooth or slightly curved surfaces.

Colors and decorations may vary.
Dolls with their accessories sold separately, subject to availability.

Not for use with other Diva Starz™ dolls.

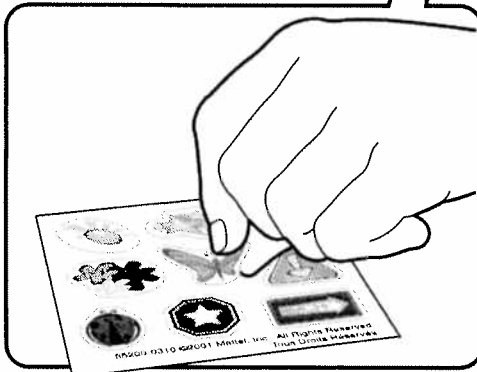

Meet the Diva Starz™ Collectible dolls!



52979 Alexa™ doll



52980 Nikki® doll



52981 Miranda™ doll



52982 Tia™ doll

Look for the Diva Starz™ Collectible dolls: Alexa™, Nikki®, Miranda™ and Tia™. They really "talk" to you and to each other! Dolls are sold separately, subject to availability.

Check out divastarz.com

2 YEAR LIMITED WARRANTY

Mattel, Inc. warrants to the original consumer purchaser that this product will be free of defects in material or workmanship for two years (unless specified in alternate warranties) from the date of purchase. If defective, return the product along with proof of the date of purchase, postage prepaid, to Consumer Relations, 636 Girard Avenue, East Aurora, New York 14052 for replacement or refund at our option. This warranty does not cover damage resulting from unauthorized modification, accident, misuse or abuse. In no event shall we be responsible for incidental, consequential, or contingent damages (except in those states that do not allow this exclusion or limitation). **Valid only in U.S.A.** This warranty gives you specific legal rights and you may also have other rights which vary from state to state. Some states do not allow the exclusion of incidental or consequential damages, so the above exclusions or limitations may not apply to you.

Send only the product to the address above. Send all correspondence to Consumer Relations, Mattel, Inc., 333 Continental Blvd., El Segundo, California 90245-5012 U.S.A. Or you may phone us toll-free at 1-800-524-TOYS, Monday - Friday, 8:00 a.m. - 6:00 p.m. Eastern Time. Outside U.S.A., see telephone directory for Mattel listing.

CONSUMER INFORMATION

MATTY MATTEL™ toys



YOU CAN TELL IT'S MATTEL!™ Call us toll-free or write with any comments or questions about our products or service. Monday - Friday 8:00 a.m. - 6:00 p.m. Eastern Time. Outside U.S.A., see telephone directory for Mattel listing.

Consumer Relations, Mattel, Inc.
333 Continental Blvd.
El Segundo, CA 90245 USA

1(800) 524-TOYS

WE ARE DEDICATED TO QUALITY PRODUCTS.